

lekkie®

01/02 ANTIJAM USER MANUAL

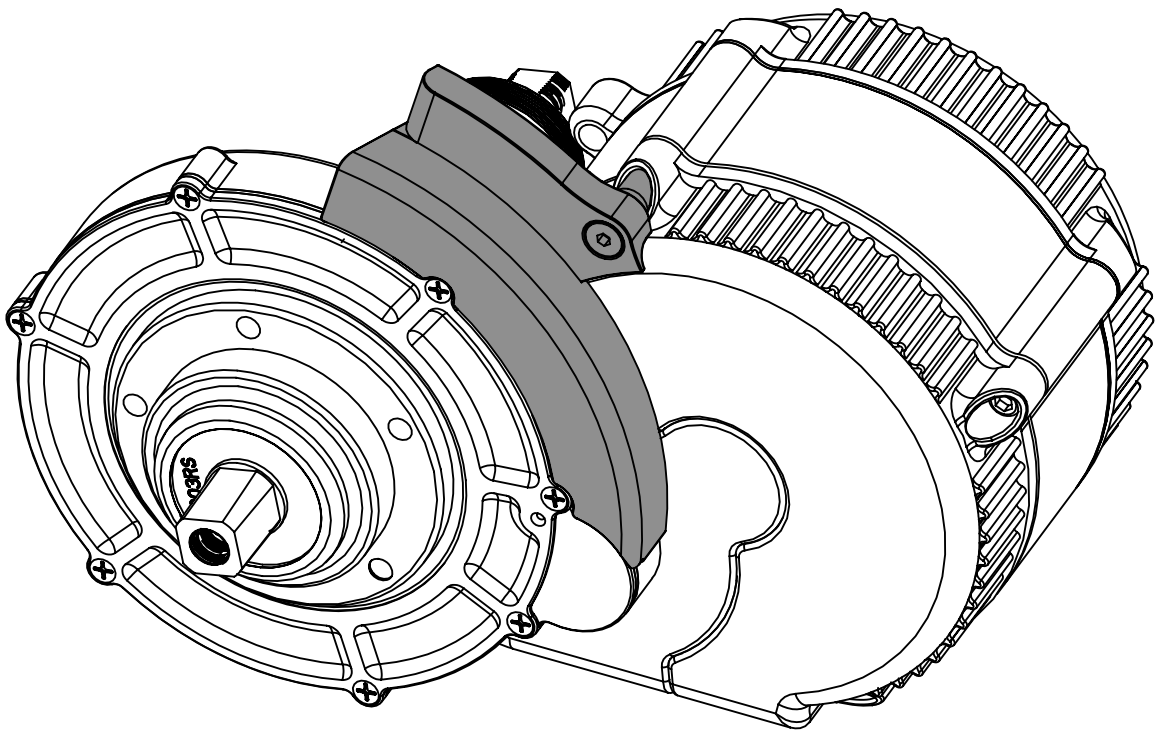

DOC V1.0

01/02 ANTIJAM

Compatible with Bafang BBS01, BBS01B, BBS02, BB02B

Adding a Lekkie Bling Ring is one of the best upgrades for your BBS01 or 02, however if you do have a chain derailment there is potential for a Jam and component breakage due to the improved offset.

The Lekkie AntiJam has been designed to assist with chain retention and prevent chain jams, but also helps eject stones to reduce the chances of getting stones wedged under the 40T Bling Ring, the leading cause for premature failure.

While these are primarily designed for running with 40T Bling Rings, they will also assist when using the 42T and wont effect the running of other size Bling Rings and standard steel rings.

The BBS01/02 version is compatible with the Lekkie BBS01/02 Drive Cover.

Includes

- 1x Lekkie 01/02 AntiJam (2x parts)
- 2x M3 Plastite screws
- 1x M4 CSK machine screw

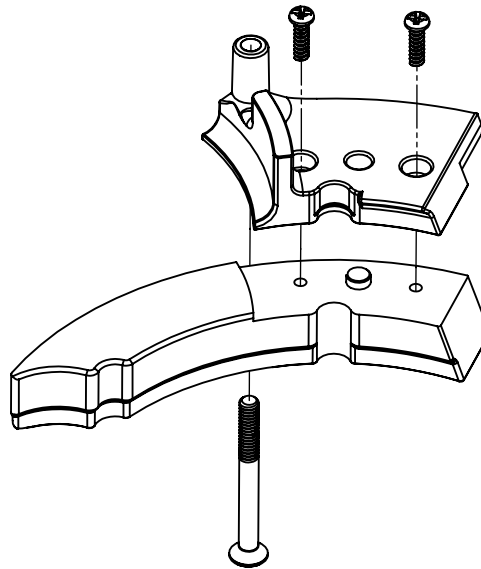

INSTALL TIPS AND TRICKS

Tools Required

- 2.5mm hex key
- 3mm hex key
- PH2 Philips screwdriver

Prep

To install the AntiJam you will need to remove the Drive-side Crank and Chain Ring, and ideally have a clean motor.

A Lekkie 01/02 Drive Cover must be used.

Install

- Remove the top M4 screw holding the controller on, clean out the mounting hole if required
- Assemble the Antijam using the 2x Philips head Plastite screws.

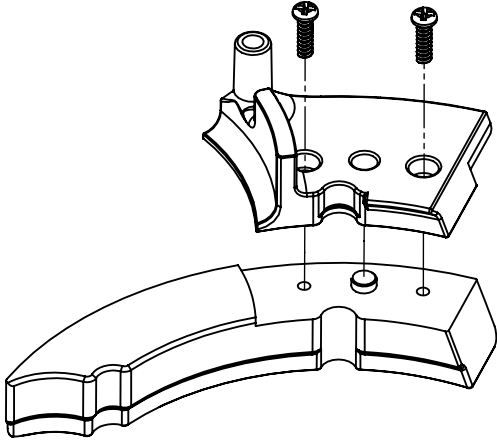

- Assemble onto the motor. Screwing in the M4 CSK to replace the Factory M4 screw.

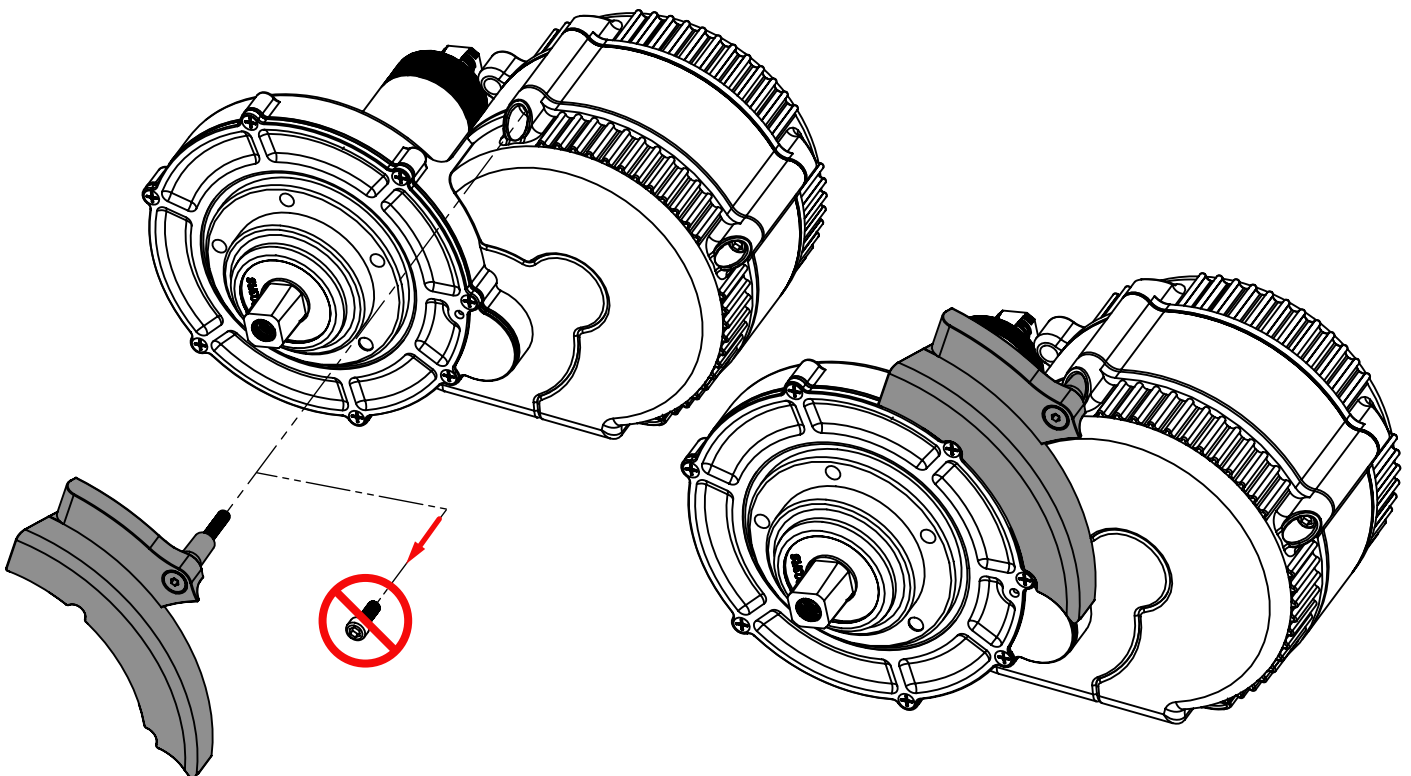

- Ensure the Antijam sits solidly against the motor and controller.
- Remount the BlingRing and check clearances before running.